

LUDOVICA
MASCHERONI
HOME ATELIER

TECHNICAL BOOK II

LUDOVICA
MASCHERONI
HOME ATELIER

LUDOVICA
MASCHERONI
HOME ATELIER

Boiserie 04

Living 14

Kitchen & Dining 38

Bedroom 60

Lamps 82

Accessories 92

Walk-in Closets 98

Alfea



Boiserie con struttura in legno rivestita in pelle, tessuto Mark Alexander e tessuto ricercato, inserti in ottone bronzato e dettagli in noce canaletto.

Wainscoting with wooden structure covered in leather, Mark Alexander fabric and refined fabric, bronzed brass inlays, details in Canaletto walnut.



Art.117_ALFEA

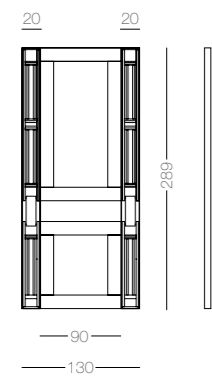

Ninfea

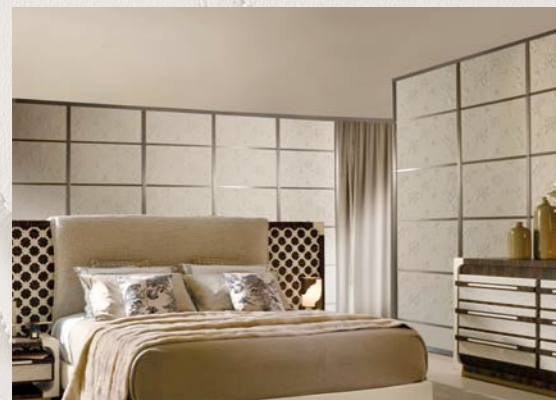

Boiserie con struttura in legno rivestito in pelle, decorazioni a fiori a rilievo e ricamo, fasce in ottone bronzato scuro.

Wainscoting with wooden structure covered in leather, embossed decorated flowers embroidery, dark bronzed brass profiles.

Art. 118_NINFEA

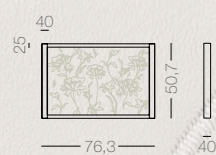

Oleandra

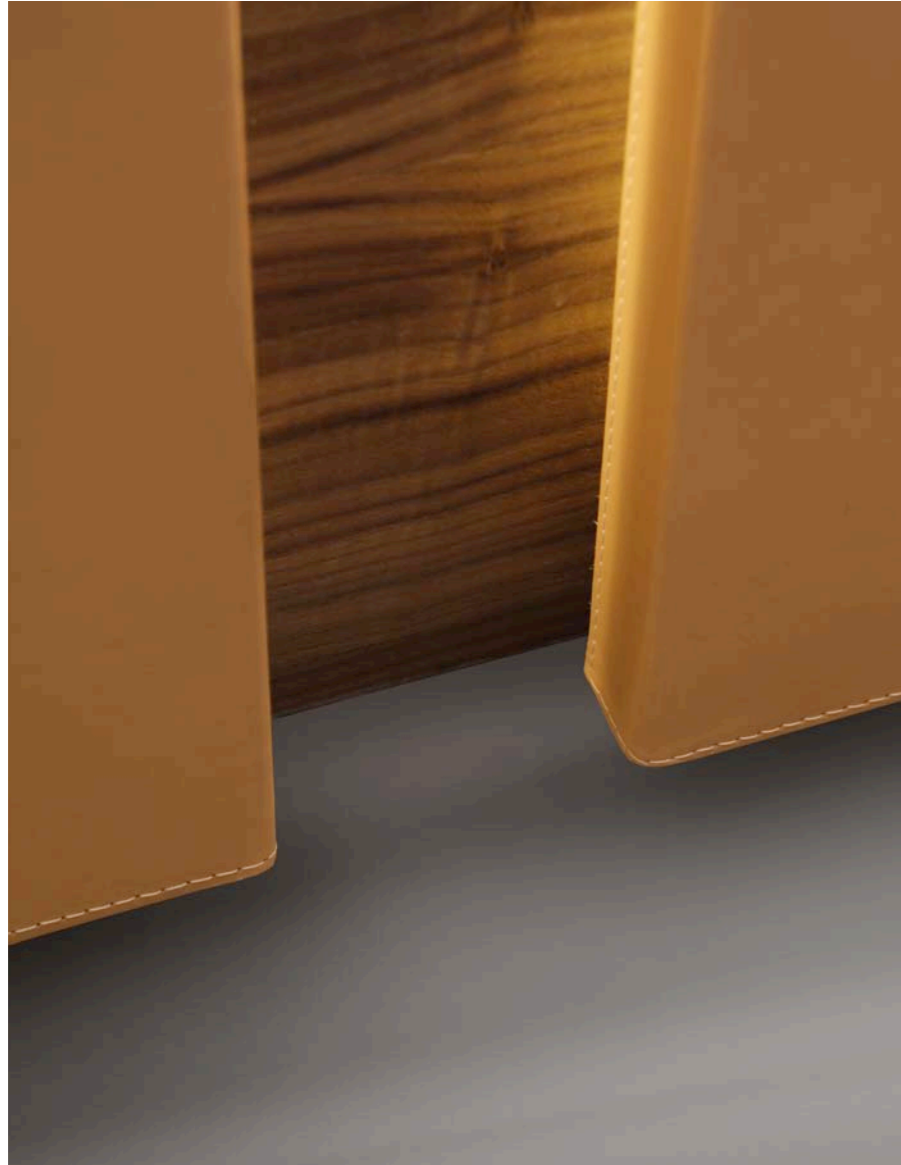

Boiserie double face composta di pannelli in legno rivestiti in pelle da un lato e in tessuto dall'altro, illuminati a led, con fasce in noce canaletto.

Two-sided wainscoting made up of wooden panels covered in leather on one side and fabric on the other, LED lighting, with strips in Canaletto walnut.

Art.119_OLEANDRA

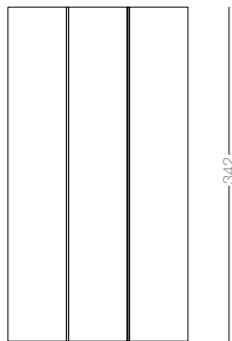

— 60 —

Armony



Boiserie con struttura in legno, parte inferiore rivestita in velluto con sagome in rilievo e parte superiore rivestita in Lino leggermente imbottito.

Wainscoting with wooden frame, lower part covered in velvet with mouldings in relief and upper part covered in lightly-padded Linen.



Art.110_ARMONY

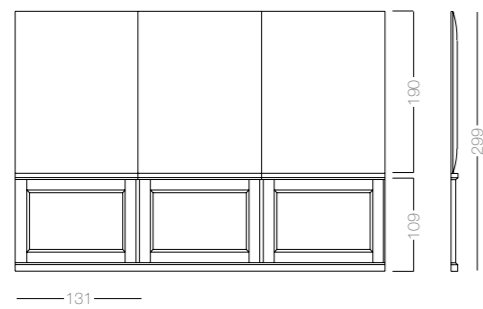

Prometeo



Boiserie con struttura in legno rivestita in pelle e tessuto. Leggera imbottitura per effetto "soft touch". Cuciture tono su tono ai rivestimenti utilizzati e dettagli in ottone bronzato.

Wainscoting with central frame covered in leather and fabric. Light padding to offer a "soft touch" effect. Tone-on-tone stitching for the covering used, and details in bronze-plated brass.

Art.114_PROMETEO

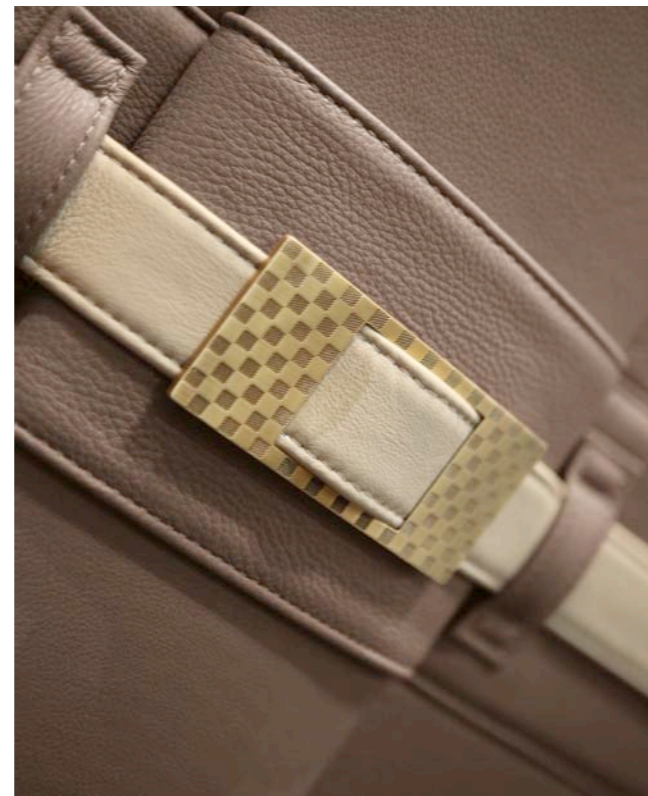
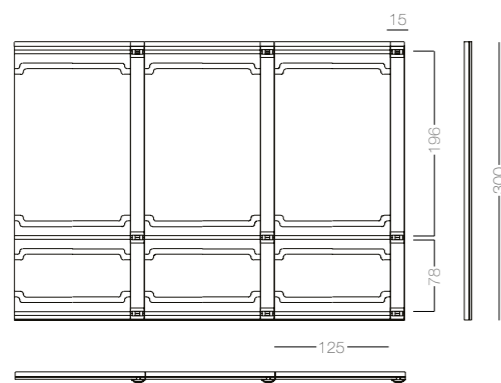

Trivio

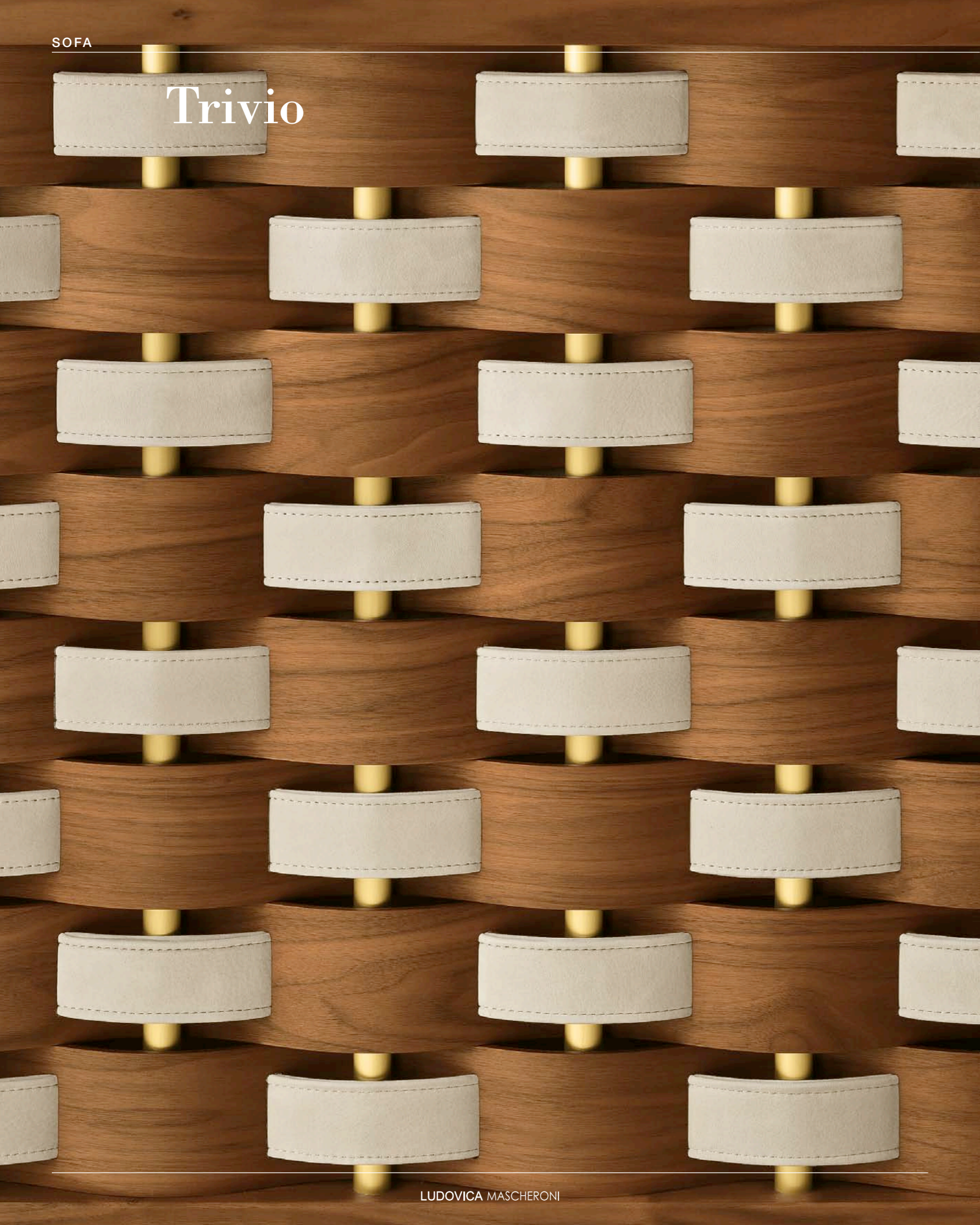

LUDOVICA MASCHERONI

Divano rivestita in velluto De Le Cuona, struttura in Noce Canaletto, intreccio di Noce Canaletto, Nubuck e tubulari in ottone bronzato con ferramenta in ottone bronzato.

Sofa covered in velvet, canaletto walnut structure with interlacing of canaletto walnut and Nubuck stripes and bronzed brass tubulars/bronzed brass hardware.

Art.214_TRIVIO

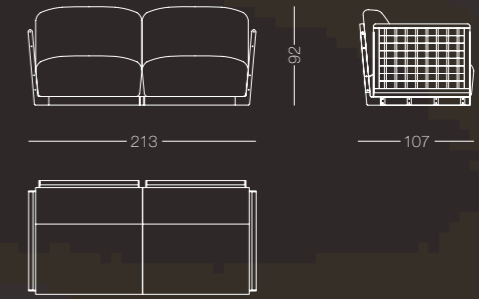

Trivio

Divano rivestito in velluto De Le Cuona, struttura in Noce Canaletto, intreccio di Noce Canaletto, Nubuck e tubulari in ottone bronzato con ferramenta in ottone bronzato.

Sofa covered in velvet, canaletto walnut structure with interlacing of canaletto walnut and Nubuck stripes and bronzed brass tubulars/bronzed brass hardware.



Art.214/A_TRIVIO

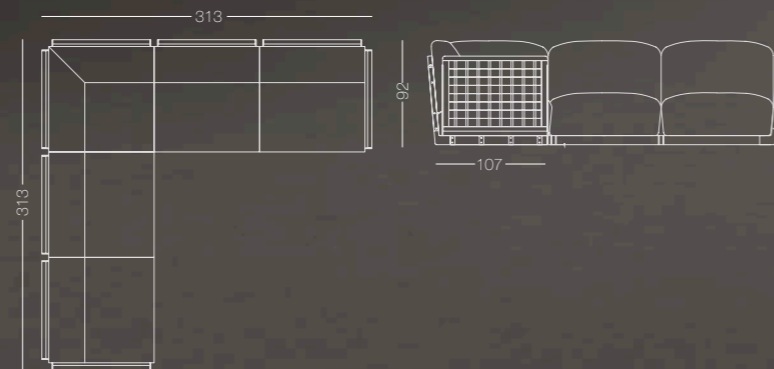

Trivio



Poltrona rivestita in velluto De Le Cuona, struttura in Noce Canaletto, intreccio di Noce Canaletto, Nubuck e tubulari in ottone bronzato con ferramenta in ottone bronzato.

Armchair covered in velvet, canaletto walnut structure with interlacing of canaletto walnut and Nubuck stripes and bronzed brass tubulars/bronzed brass hardware.



Art.319_TRIVIO

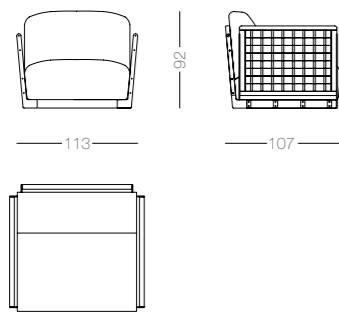

Italo

Divano con fusto in legno di faggio, sistema di molleggio tradizionale con molle, cinghie elastiche intrecciate, fibre vegetali e crine di cavallo, imbottitura in piuma d'oca e poliuretano espanso, rivestito in pelle e cuscini in soffice piuma d'oca. Dettaglio bracciolo in Marmo Portoro con profili e piedini in ottone bronzato.

Sofa with frame in beech wood, traditional suspension system on springs, interwoven elastic straps, vegetable fibres and horsehair. Padding in goose feather and foamed polyurethane, covering in leather and cushions in soft goose feather.

Details of the armrest in Portoro Marble with profiles and feet in bronze-plated brass.

Art.215_ITALO

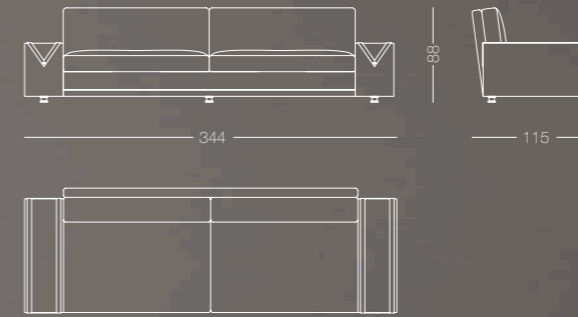

Altea



Chaise longue con struttura in legno, imbottitura in poliuretano espanso, rivestita in pelle con cuciture tono su tono. Struttura piedi in legno rivestita in pelle e dettagli in ottone bronzato.

Chaise longue with wooden frame, foamed polyurethane padding, upholstered in leather with tone-on-tone stitching. Feet frame in wood covered in leather and bronze-plated brass details.

Art.320_ALTEA

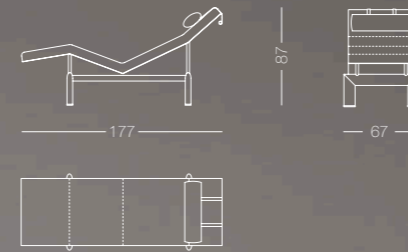

Titano



Divano con fusto in legno di Faggio, sistema di molleggio tradizionale con molle, cinghie elastiche intrecciate, fibre vegetali e crine di cavallo. Struttura esterna rivestita in cuoio, cuscini seduta e schienale in velluto.

Sofa with wooden frame in Beech, traditional suspension system, elastic interwoven straps, vegetable fibres and horsehair. External structure covered in thick leather, with seat and back cushions in velvet.

Art.213_TITANO

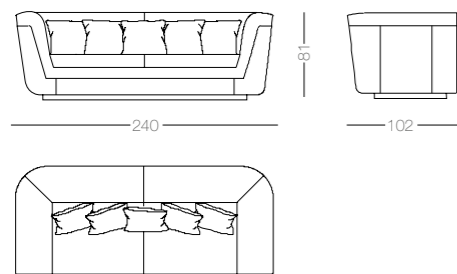

Nota bene:
Prodotto non smontabile

*Take a notice:
Product cannot be disassembled*



Art.213/A_TITANO

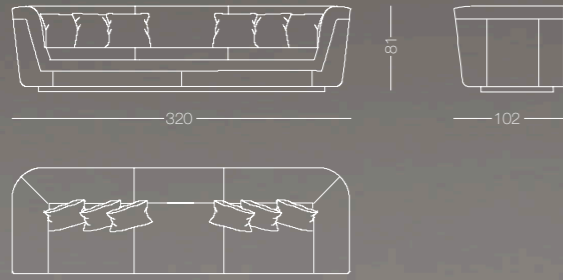

Nota bene:
Prodotto non smontabile

*Take a notice:
Product cannot be disassembled*



Titano



Poltrona con fusto in legno di Faggio, sistema di molleggio tradizionale con molle, cinghie elastiche intrecciate, fibre vegetali e crine di cavallo. Struttura esterna rivestita in cuoio, cuscini seduta e schienale in velluto.

Armchair with Beech wood frame, traditional suspension system on springs and interwoven elastic straps, padding in expanded polyurethane. Outer cover in Nubuck, back and seat in fabric. Perforated openwork with "brogue" pattern on the outer part of the armrests and backrest.

Art.318_TITANO

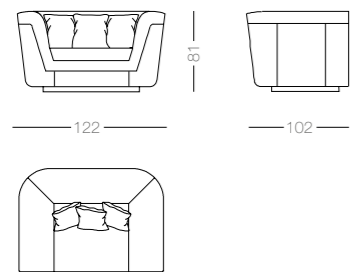

Oxford Club

Poltrona con fusto in legno di Faggio, sistema di molleggio tradizionale con molle e cinghie elastiche intrecciate, imbottitura in poliuretano espanso. Rivestimento esterno in Nubuck, seduta e schienale in tessuto. Lavorazione traforata con decoro "brogue" su esterno braccioli e schienale.

Armchair with Beech wood frame, traditional suspension system on springs and interwoven elastic straps, padding in expanded polyurethane. Outer cover in Nubuck, back and seat in fabric. Perforated openwork with brogue decoration on the outer part of the armrests and backrest.

Art.317_ OXFORD CLUB

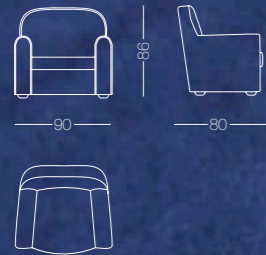

Trivio



Tavolo caffè con struttura in Noce Canaletto, ferramenta in ottone bronzato, piano in marmo Grigio Reale e fasce laterali in Nubuck.

Small table with Canaletto walnut structure, bronzed brass hardware, Grigio reale marble top, Nubuck folders.

Art.507_TRIVIO

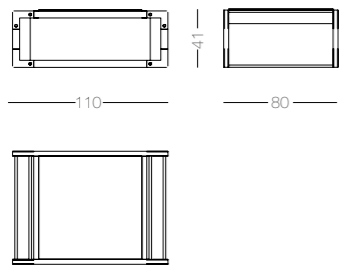

Alceo



Tavolino con struttura in legno rivestita in pelle, piano in marmo Portoro, piedini e dettagli in ottone bronzato.

Small table with leather-covered wooden frame, top in Portoro marble, feet and details in bronze-plated brass.



Art.508_ALCEO

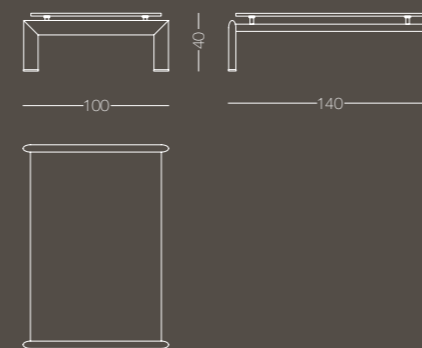

Eclisse



Tavolino con struttura rotante in legno rivestita in Nubuck e scomparto portabottiglie, struttura semicircolare rotante in ottone bronzato.

Small table with swivel frame in Nubuck covered wood and bottle storage area, semi-circular swivel frame in bronze-plated brass.

Art.410_ECLISSE

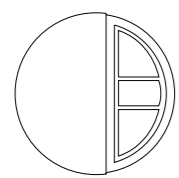
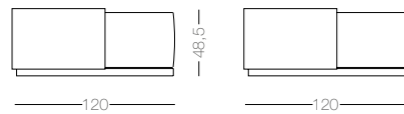

Michelin A

Cucina rivestita in cuoio ignifugo, antimacchia e resistente all'umidità, con dettagli in legno in essenza di Ziricote. Maniglie in ottone bronzato, rivestite internamente in nubuk. Piano di lavoro, colonna centrale e paraschizzi in pregiata Quarzite retroilluminata. Zoccolatura in ottone bronzato. La cucina è composta da cantina vini, macchina da caffè, forno a vapore con microonde, macchina del ghiaccio, lavastoviglie, ed altri elettrodomestici di alta gamma. Estrazione cassette e antine motorizzati. Interno cassette comprensivi di Tappetini in Nubuk e altri raffinati dettagli. Impianto Tv ad attivazione dal controsoffitto.

Art.2601_MICHELIN A

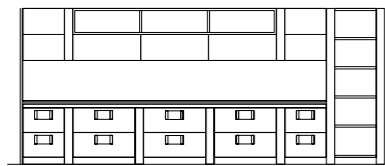

530

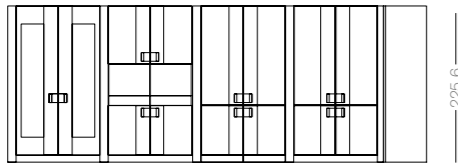

541,7

225,6

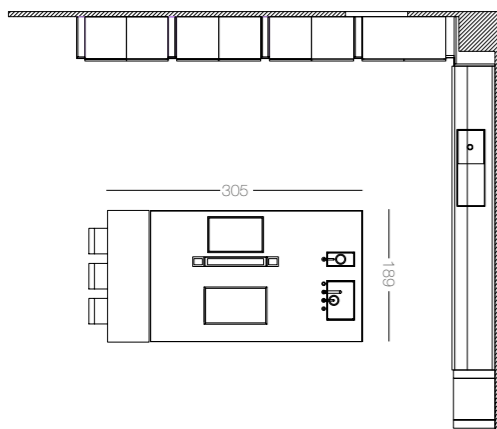

305

681

Kitchen covered with fire-resistant, stain-resistant and moisture-resistant thick leather, with wooden details in Ziricote. Bronze-plated brass handles, internally covered in Nubuck. Worktop, central column and back splash in fine Quartzite with backlighting.

Skirting board in bronze-plated brass.

The kitchen includes a wine cellar, coffee machine, steam oven with microwave, ice-maker, dishwasher, and other high-end appliances. Motorized drawers and doors. Drawer interiors including mats in Nubuck and other sophisticated details. TV system activated from the false ceiling.

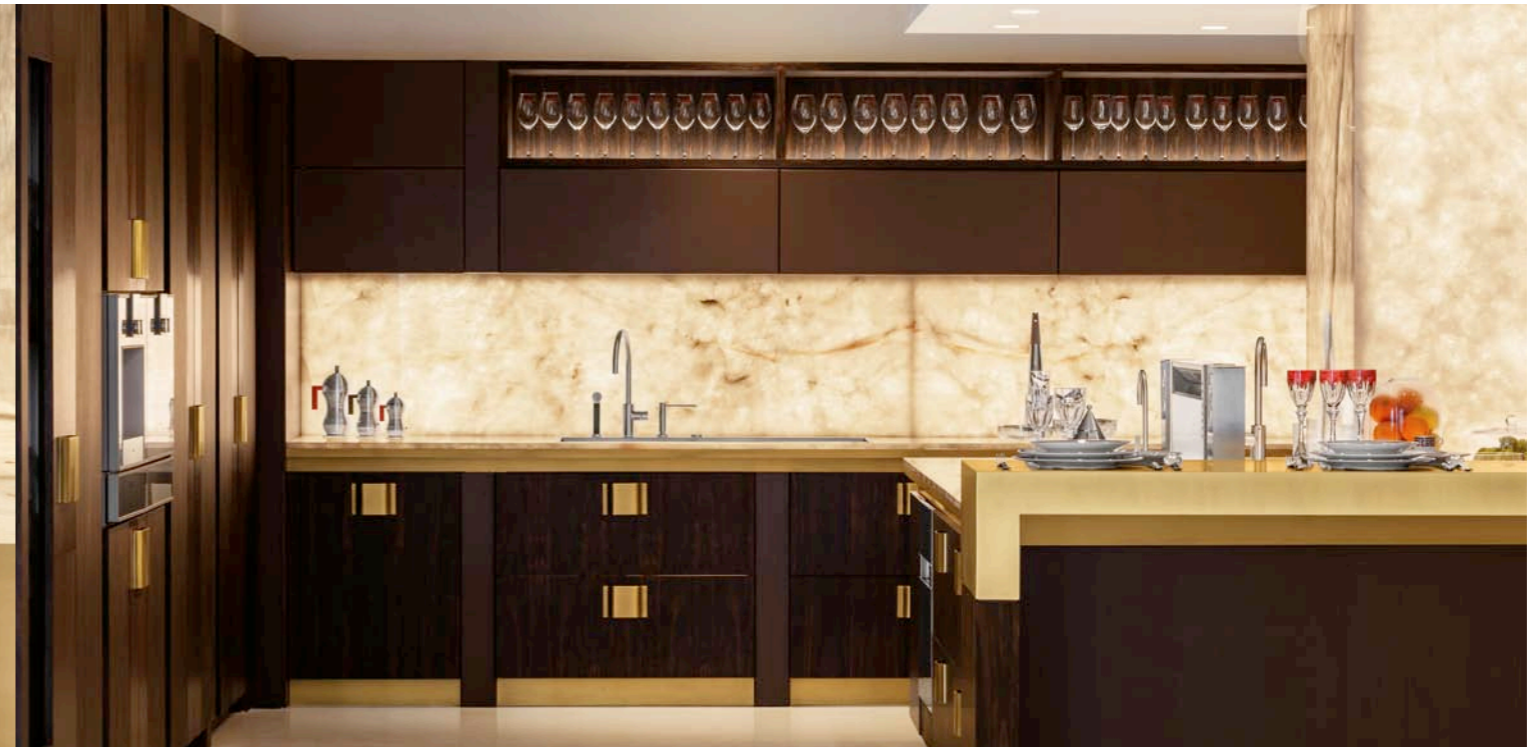

Luxury Refissa

Sedia con struttura in noce canaletto, ferramenta in ottone placcato oro bianco lucido e rivestimento in cuoio naturale con cuscino di seduta e schienale in coccodrillo.

Chair with Canaletto walnut, white shiny gold plated on brass hardware, covering in genuine cow leather with genuine crocodile back and seat cushions.

Art.712_LUXURY REFISSA

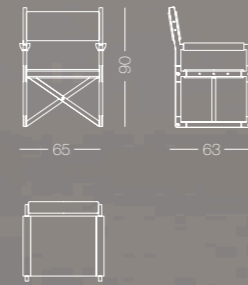

Refissa



Sedia con struttura in Noce Canaletto, ferramenta in ottone bronzato e rivestimento in cuoio naturale.

Chair with Canaletto walnut, bronzed brass hardware, covering in genuine cow leather.

Art. 712_REFISSA

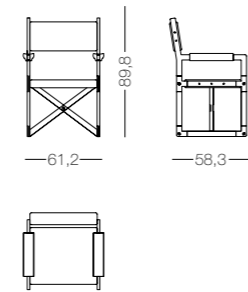

Refissa



Balmoral



Poltroncina con struttura in legno, imbottita in poliuretano espanso, esterno rivestito in pelle con cuciture tono su tono. Schienale e seduta in velluto, piedini in ottone bronzato.

Small armchair with wooden frame, padding in expanded polyurethane, external covered in leather with tone-on-tone stitching. Backrest and seat in velvet, legs in bronze-plated brass.

Art. 711_BALMORAL

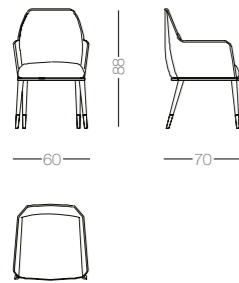

Refisso



Tavolo con piano in Noce Canaletto con inserti in pelle e profili di metallo inseriti nel piano, gamba centrale in noce canaletto con dettagli in pelle e ferramenta in ottone bronzato.

Dining table in canaletto walnut, leather inlays on the top and bronzed brass profile inlays in the depth of the wood.

Art.613_REFISSO

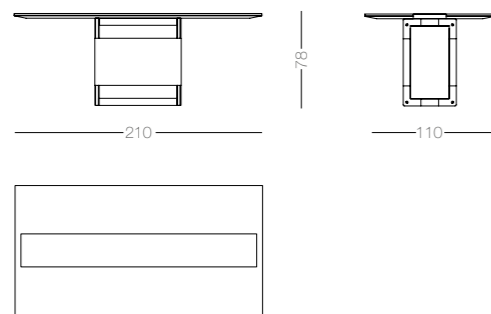

Balmoral



Tavolo con struttura in legno rivestita in pelle con cuciture tono su tono. Piano in marmo Black & Gold, inserti e dettagli in ottone bronzato.

Table with wooden frame covered in leather with tone-on-tone stitching. Black & Gold marble top, inserts and details in bronze-plated brass.

Art.612_BALMORAL

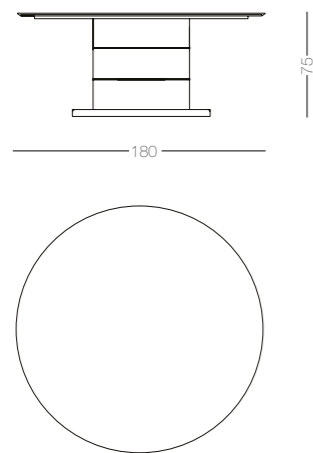

Alfio



Bancone con gambe in essenza zircote con top in ottone bronzato.

Counter top with legs in Ziricote wood and top in bronze-plated brass.

Art.614_ALFIO

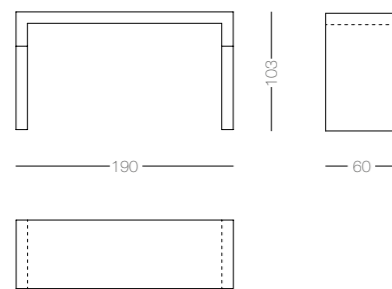

Oliviero

Sgabello con struttura in legno di faggio con imbottitura in piuma d'oca e poliuretano espanso rivestita in nubuk piedini in ottone bronzato.

Stool with beech wood frame, padded with goose feather and foamed polyurethane covered in Nubuck and feet in bronze-plated brass.



Art. 713_OLIVIERO

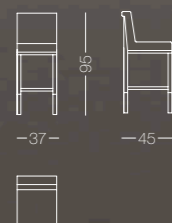

Ossidania



Madia con struttura in legno rivestito in cuoio, Noce Canaletto con profili in ottone bronzato, ferramenta in ottone bronzato.

Sideboard with wood structure covered in leather, canaletto walnut with bronzed brass inlays, bronzed brass hardware.

Art.809_OSSIDANIA

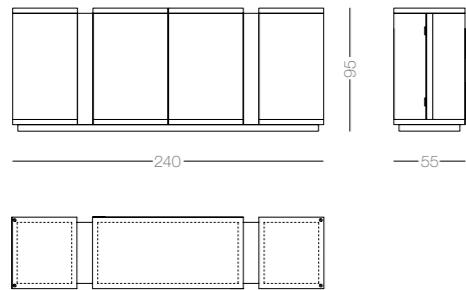

Balmoral



Credenza con struttura in legno rivestita in pelle con cuciture tono su tono, interno in essenza Ziricote laccato lucido poliester. Top in marmo Black & Gold. Inserti e maniglie in ottone bronzato. Illuminazione led interna con sensore di apertura.

Sideboard with wooden frame covered in leather with tone-on-tone stitching, interior in Ziricote wood with glossy lacquered polyester finish. Black & Gold marble top. Inserts and handles in bronze-plated brass. LED interior lighting with opening sensors.

Art.808_BALMORAL

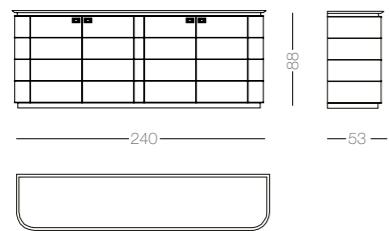

Krystal

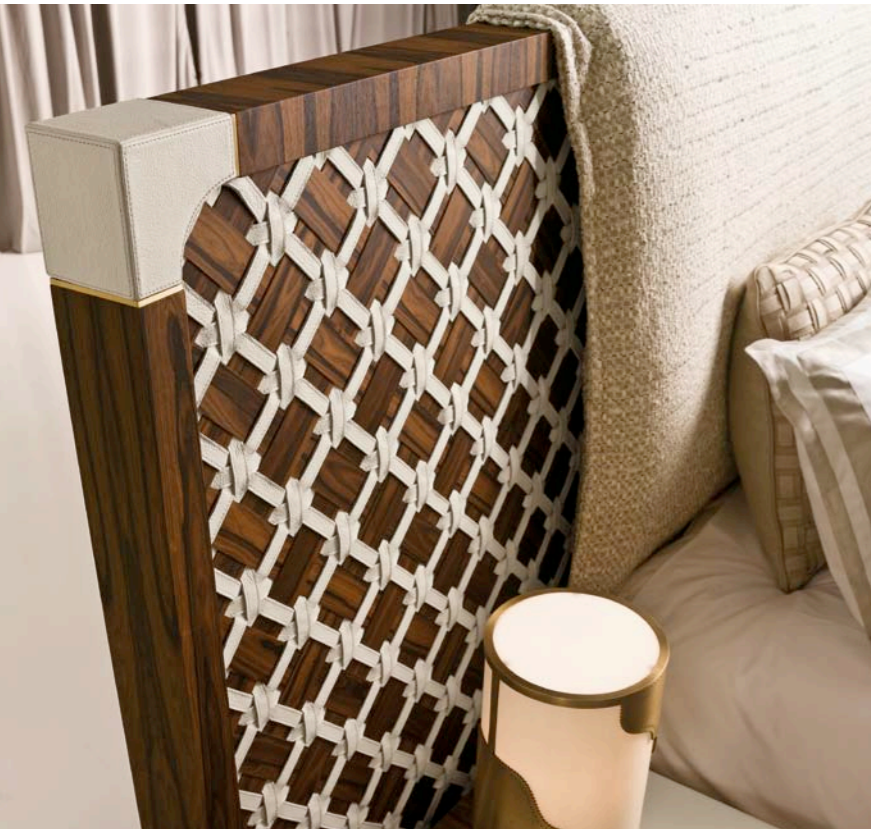

Letto con struttura, testata e cornice in legno Zircote, angolari in pelle e inserti in ottone bronzato.

Bed structure in zircote wood with corners covered in leather and bronzed brass inlays. Headboard with interlaced zircote wood stripes and leather, headboard frame in zircote wood with corners in leather and bronzed brass inlays.

Art.1211_KRYSTAL

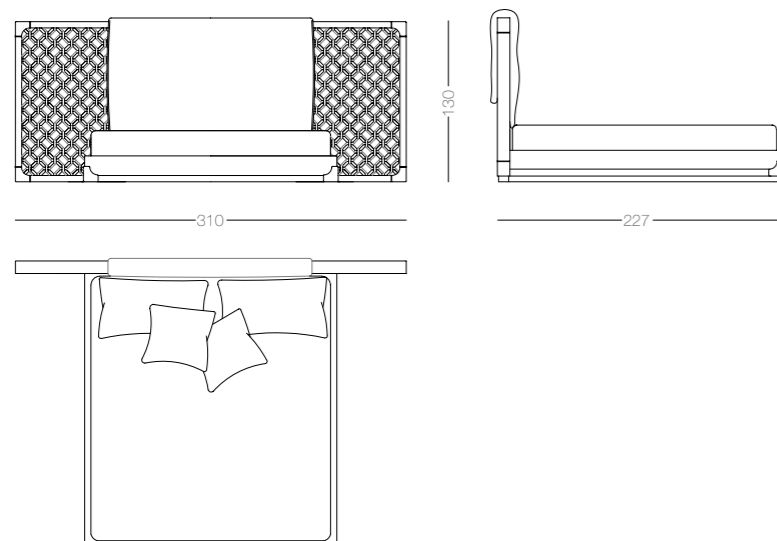

Krystal

Comò con struttura in legno di Ziricote rivestita in pelle, inserti in ottone bronzato e frontale cassetto rivestito in tessuto De Le Cuona.

Chest of drawer with wooden structure covered in leather, ziricote wood, bronzed brass inlays, front drawer covered in De Le Cuona fabric.

Art.1113/A_KRYSTAL

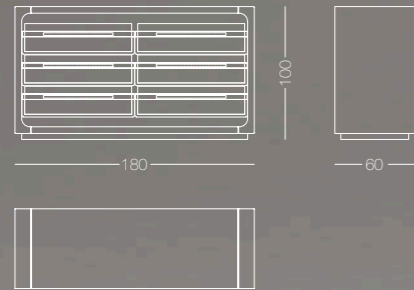

Art.1113/B_KRYSTAL

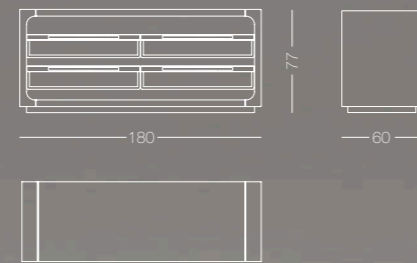

Krystal

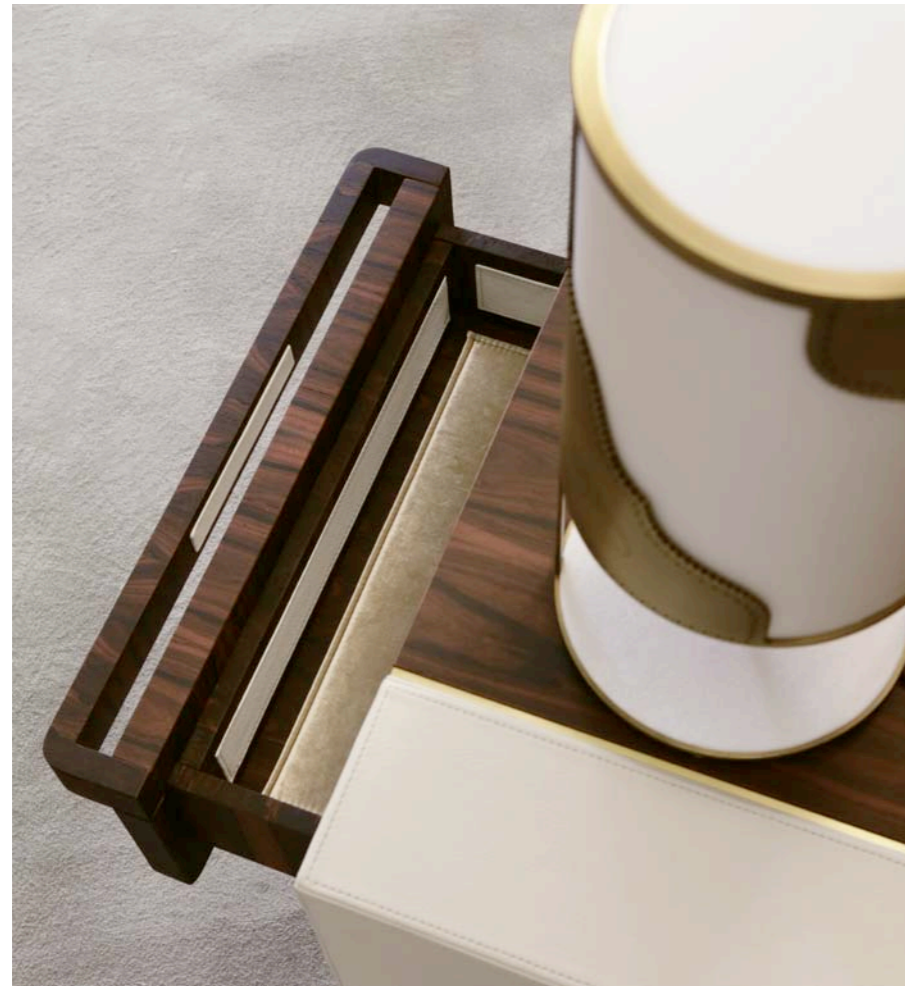

Comodino con struttura in legno di Zircote rivestita in pelle, inserti in ottone bronzato e frontale cassetto rivestito in tessuto De Le Cuona.

Bedside table with wooden structure covered in leather, zircote wood, bronzed brass inlays, front drawer covered in De Le Cuona fabric.

Art.1312/A_KRYSTAL

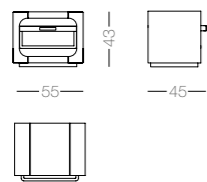

Art.1312/B_KRYSTAL

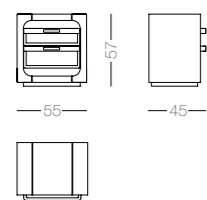

Krystal

Settimanale con struttura in legno di Ziricote rivestita in pelle, inserti in ottone bronzato e frontale cassetto rivestito in tessuto De Le Cuona.

6-drawers with wooden structure covered in leather, ziricote wood, bronzed brass inlays, front drawer covered in De Le Cuona fabric.

Art. 1405_KRYSTAL

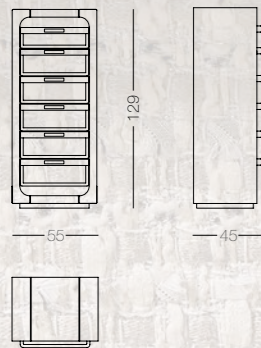

Oxford Club



Letto con struttura in legno e testata attrezzata. Rivestimento in pelle e velluto. Dettagli in pelle traforata con decoro brogue, basamento in essenza Sucupira.

Bed with wooden frame and equipped headboard. Cover in leather and velvet. Details in perforated openwork leather with brogue decoration, base and shelves in Sucupira wood.

Art.1210_OXFORD CLUB

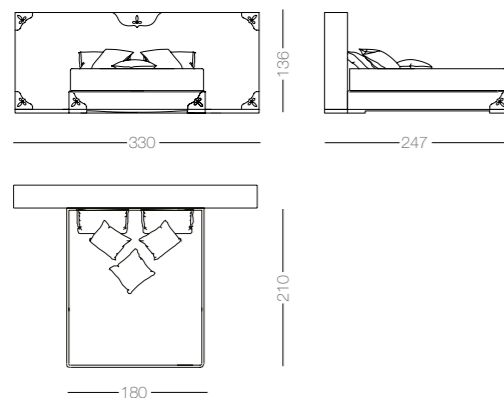

Oxford Club

Retro testata letto con vani a giorno, spalle e schienale in legno essenza Sucupira e ripiani rivestiti in pelle.

Back headboard with open compartments, back panels and sides in Sucupira wood and shelves covered in leather.

Art.1210_OXFORD CLUB

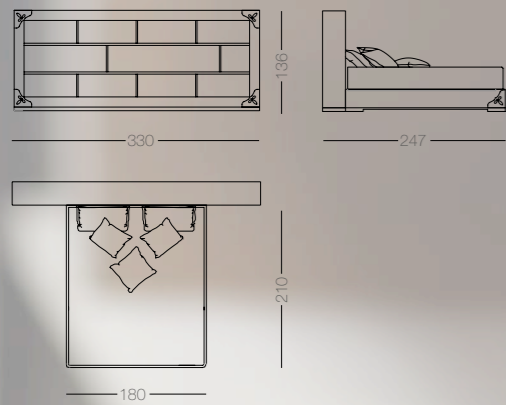

Oxford

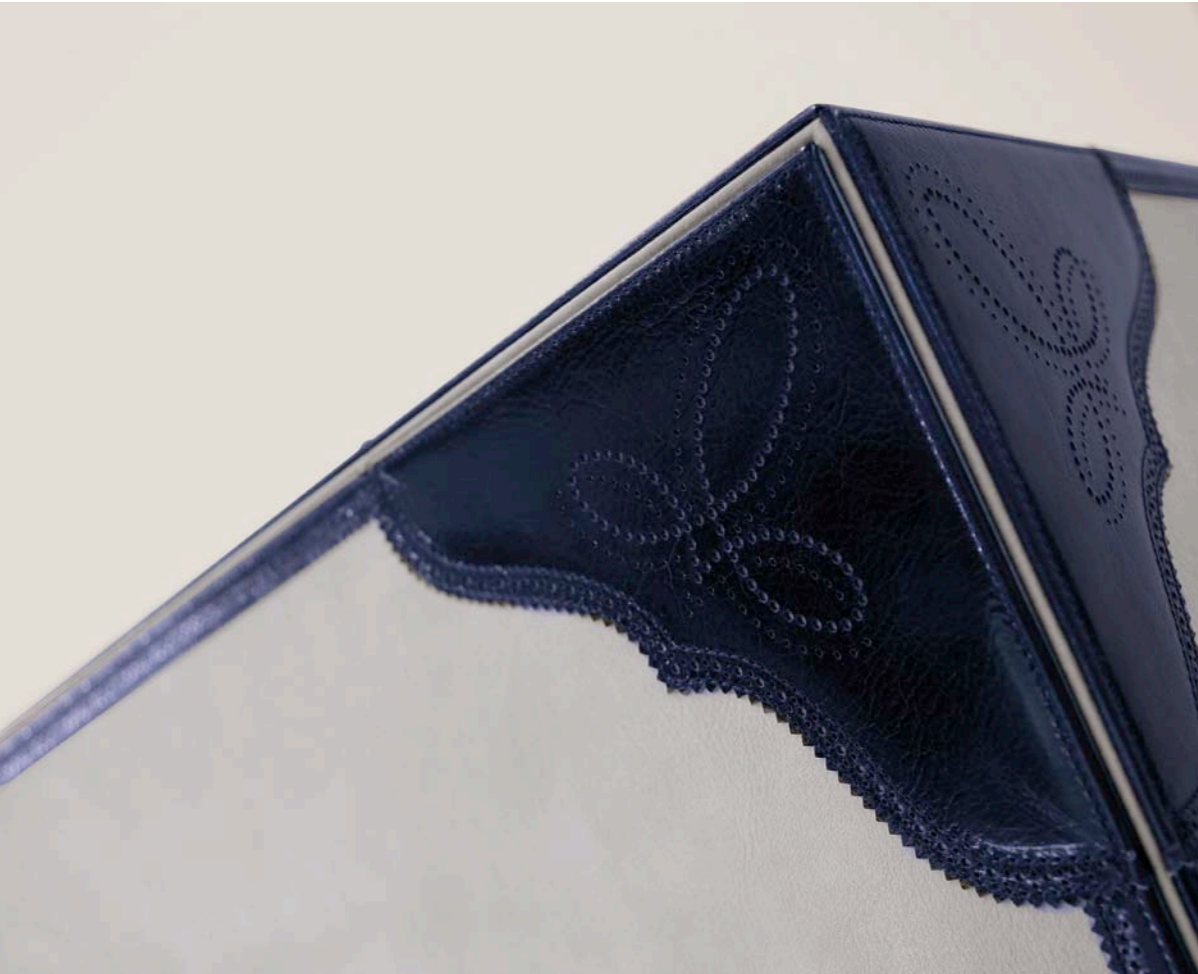

Comò a tre cassetti con struttura in legno rivestita in pelle, dettagli in pelle traforata con decoro brogue, cuciture a mano tono su tono. interno cassetti in lino e pelle. Basamento in ottone bronzato; disponibile anche nella versione in legno essenza sucupira.

3-drawers dresser with wooden frame covered in leather, details in perforated leather with brogue decoration and tone-on-tone hand stitching. Interior of drawers in linen and leather. Base in bronze-plated brass, also available in the version in Sucupira wood.

Art.1112_OXFORD

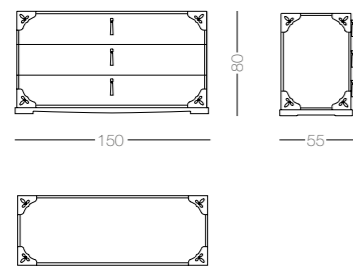

Oxford



Comodino con struttura in legno rivestita in pelle, dettagli in pelle traforata con decoro brogue, cuciture a mano tono su tono. Interno cassetti in lino e pelle. Basamento in ottone bronzato; disponibile anche nella versione in legno essenza Sucupira.

Bedside table with wooden structure covered in leather, details in perforated leather with brogue decoration and tone-on-tone handmade stitching. Interior of drawers in linen and leather. Base in bronze-plated brass – also available in the version with Sucupira wood.

Art.1310/A_OXFORD

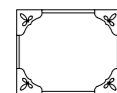
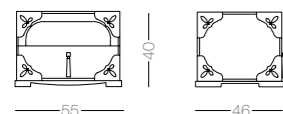

Art.1310/B_OXFORD

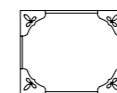
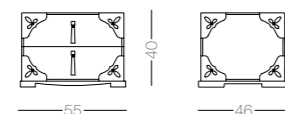

Art.1310/C_OXFORD

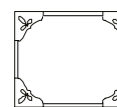
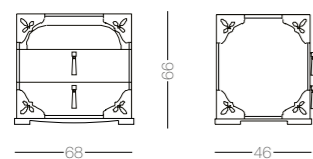

Oxford



Settimanale con struttura in legno rivestito in cotone misto lino con dettagli in pelle traforata con decoro brogue. Interno cassetti in lino e pelle con cuciture a mano tono su tono. Basamento in ottone bronzato; disponibile anche nella versione in legno essenza Sucupira.

6-drawers unit with wooden frame covered in cotton-linen, details in perforated leather with brogue decoration and tone-on-tone handmade stitching. Interior of drawers in linen and leather. Base in bronze-plated brass – also available in the version with Sucupira wood.

Art.1404_oxford

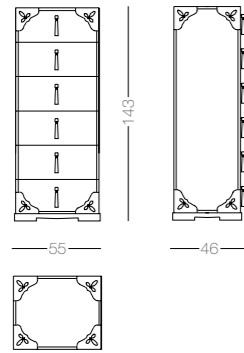

Art.1404_oxford XL

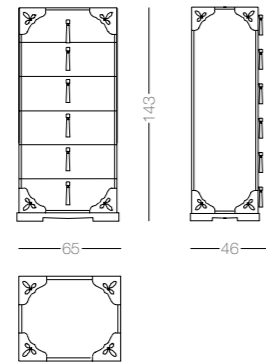

Prezioso



Armadio con struttura in legno rivestita in pelle, ante quadro interno Zircote rivestite in pelle traforata, ante quadro esterno Zircote e vetro bronzato, maniglie in legno Zircote con inserti in pelle. Cornice armadio in legno rivestito in pelle retro illuminata sfondo Zircote, carrelli ad estrazione telecomandata, pannelli di fondo retro illuminati rivestiti con tessuto De Le Cuona, inserti in ottone bronzato.

Wardrobe with wood structure covered in leather, zircote central doors covered with perforated leather, bronzed glass in zircote frame doors, zircote handles with leather inlays. Backlighting wardrobe frame covered in leather on zircote contrast, containers with remote opening system, backlit panels covered in De Le Cuona fabric, bronzed brass inlays.



Art.1605_PREZIOSO

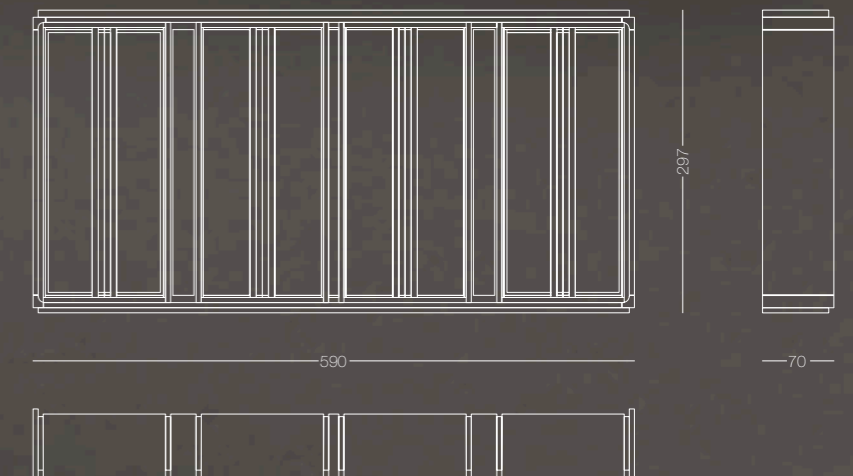

Jackie



Baule trucco con struttura in legno rivestita esternamente in pelle e internamente in Nubuck. Dettagli: lavorazione ricamata, vani e cassetti porta oggetti, led dimerabile, vetro "stop sol" con monitor integrato, appendi abiti e particolari verniciati in finitura oro.

Beauty chest with wooden frame, outer covering in leather and interior in Nubuck. Details: embroidered workmanship, shelves and drawers, dimmable LED, "stop sol" glass with integrated monitor, clothes hangers and details painted in gold finish.

Art.1005_JACKIE

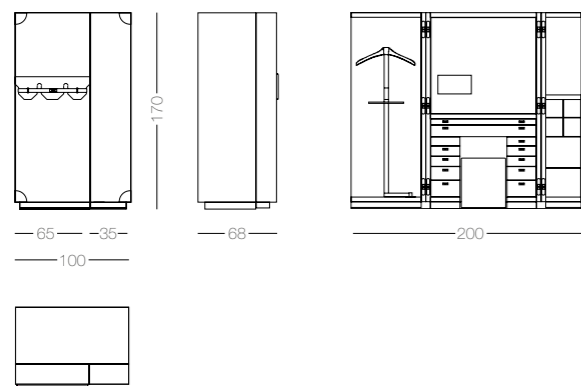

Trivio



Lampada piantana con struttura in ottone bronzato, pastiglie in vetro e dettagli in cuoio. Piantana in ottone bronzato rivestita in cuoio con base in ottone bronzato, ferramenta in ottone bronzato.

Lamp with bronzed brass structure, glass pads and leather details. Bronzed brass upright lamp structure covered in leather, bronzed brass base and bronzed brass hardware.



Art.2113_TRIVIO

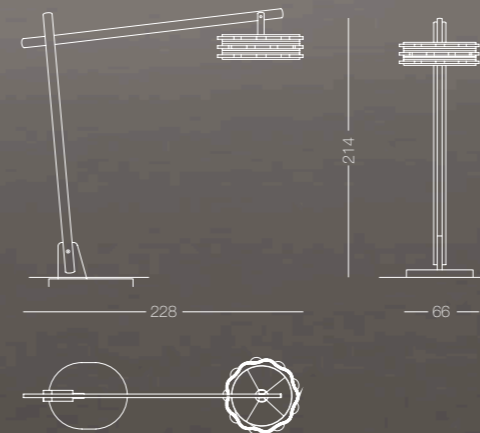

Trivio



Lampada a sospensione con struttura in ottone bronzato, pastiglie in vetro e dettagli in cuoio.

Lamp with bronzed brass structure, glass pads and leather details.

Art.2112_TRIVIO

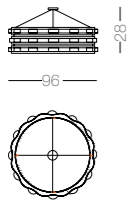

Oxford



Lampada a soffitto con struttura in ottone bronzato, paralume con dettagli traforati con decoro brogue.

Ceiling lamp with frame in bronzed brass, lampshade with perforated details and brogue decoration.

**Art.2107/A
OXFORD**

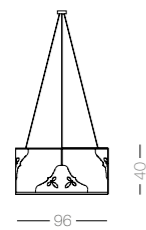

**Art.2107/B
OXFORD**

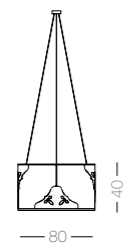

**Art.2107/C
OXFORD**

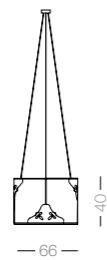

Oxford

Applique con struttura in ottone bronzato e paralume con dettagli traforati con decoro brogue.

Wall lamp with bronze-plated frame and lampshade with perforated details and brogue decoration.

Art.2110_ OXFORD APPLIQUE

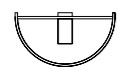
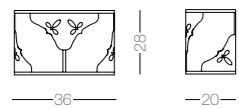

Oxford



Lampada da tavolo con struttura in ottone bronzato, paralume con dettagli traforati con decoro brogue.

Table lamp with frame in bronzed brass, lampshade with perforated details and brogue decoration.

Art.2106_OXFORD

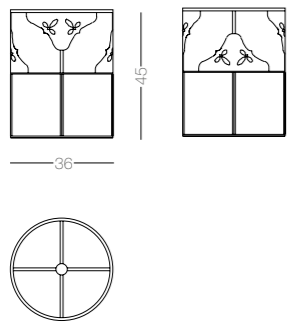

Trivio

Paravento con struttura tubolare in ottone bronzato, con intreccio di fasce Nubuck-Cotone Loro Piana.

Tubular structure with interlaced Loro Piana cotton-Nubuck stripes.

Art.2402_TRIVIO

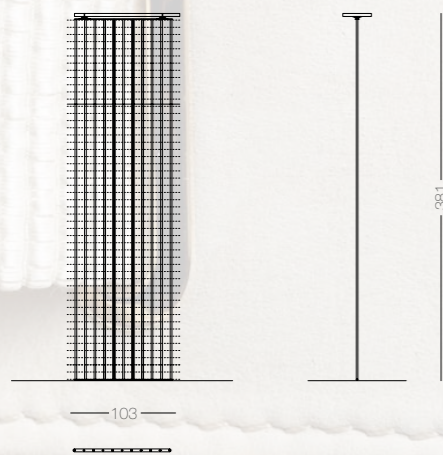

Hide

Mobile TV girevole struttura contenitore in Noce Canaletto, TV led integrata e pannelli in pelle forati per la diffusione del suono, girevole su perno in ottone bronzato, TV visibile da un lato e specchio dall'altro lato, ferramenta in ottone bronzato.

Swivel TV-Unit with Canaletto walnut container structure, TV led integrated, perforated leather panels for sound diffusion, bronzed brass tubular pivot for swivel system sharing TV on one side and mirror on the other side.



Art.2501_HYDE

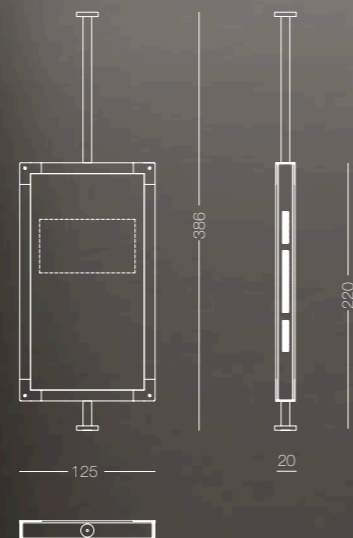

Oxford



Specchiera con cornice in legno rivestita in pelle, dettagli in pelle traforata con decoro brogue e cuciture a mano tono su tono.

Mirror with wooden frame covered in leather, perforated leather details with brogue decorations and hand-made tone-on-tone stitching.

Art.1806_OXFORD

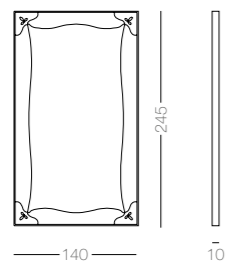

Prezioso



Cabina armadio con struttura in legno rivestita in pelle, ante quadro interno Ziricote rivestite in pelle traforata, maniglie in legno Ziricote con inserti in pelle. Cornice armadio in legno rivestito in pelle retro illuminata sfondo Ziricote, carrelli ad estrazione telecomandata, pannelli di fondo retro illuminati rivestiti con tessuto De Le Cuona, inserti in ottone bronzato.

Walk-in closet with wood structure covered in leather, ziricote central doors covered with perforated leather, ziricote handles with leather inlays.

Backlighting wardrobe frame covered in leather on ziricote contrast, containers with remote opening system, backlighting panels covered in De Le Cuona fabric, bronzed brass inlays.



Oxford Club



Cabina armadio completamente rivestita in Nubuck e cuoio naturale tamponato a mano. Schienali: pannelli con illuminazione led uniforme sulla superficie, rivestiti in tessuto. Dettagli traforati con decoro "brogue" e interno cassetti in pelle e lino naturale. Accessori: strisce led sotto ripiani, "servetto" ed estrazione colonne per accessori motorizzati, ripiani porta scarpe in vetro extrachiaro e dettagli ottone bronzato.

Walk-in closet completely covered in Nubuck and natural thick leather with hand-padded finish. Back panels: panels with LED lighting, uniform on the surface, covered with fabric. Perforated details with "brogue" decorations and interior of drawers in leather and natural linen. Accessories: LED strips under the shelves, "Clothes lift" and pull-out columns for motorized accessories, shelves for shoes in extra-clear glass and bronze-plated brass details.

Art.1604_ OXFORD CLUB

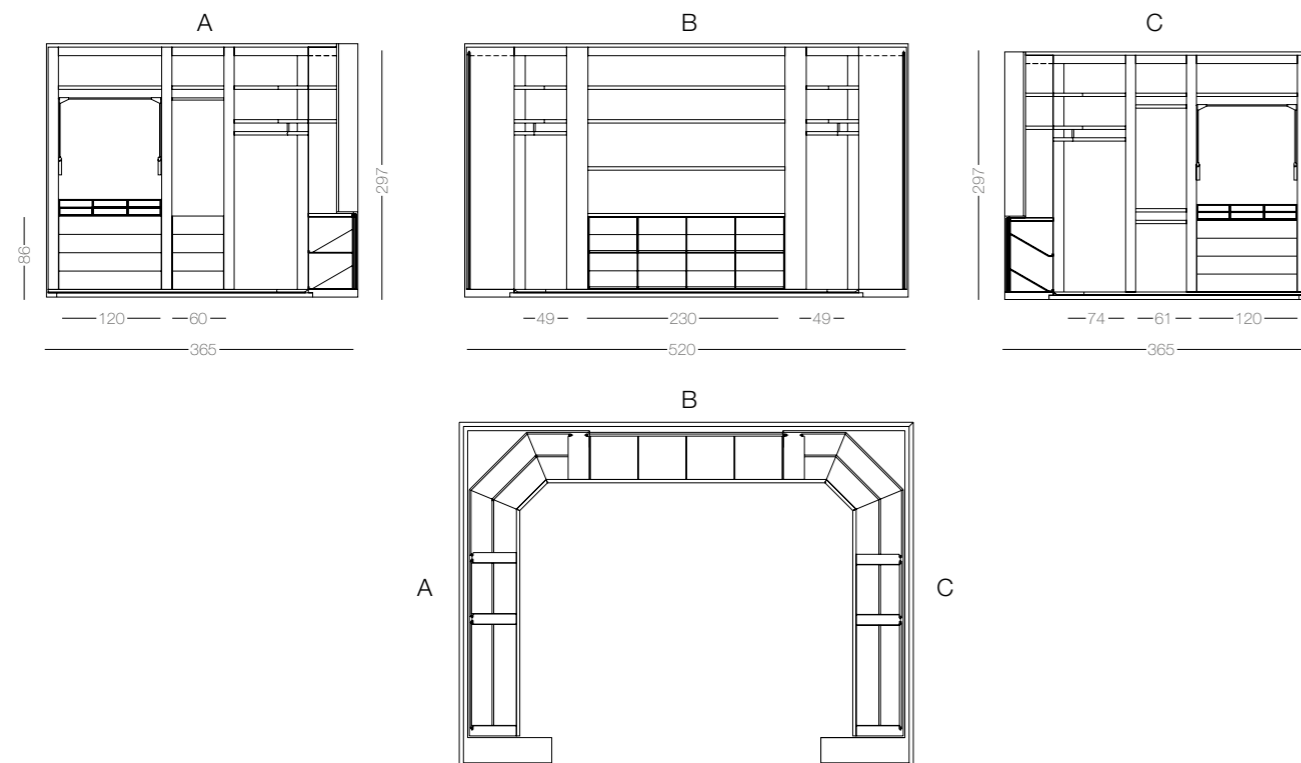

I materiali Materials



Essenze

Essences



ROVERE NATURALE
NATURAL OAK



ROVERE AFFUMICATO
SMOKED OAK



ROVERE CHIARO
LIGHT OAK



NOCE CANALETTO
CANALETTO WALNUT



ZIRICOTE
ZIRICOTE



EBANO MAKASSAR
MAKASSAR EBONY



SUCUPIRA
SUCUPIRA



EUCALIPTO
EUCALYPTUS



CEDRO
CEDAR



EBANO AMARA
AMARA EBONY

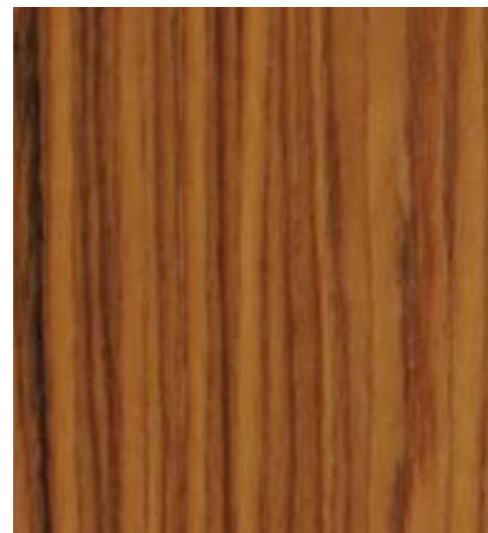

PALISSANDRO SANTOS
SANTOS ROSEWOOD



ROVERE MORO
DARK OAK



TANGANIKI FIAMMATO
FLAMING TANGANYIKA



ACERO SICOMORO
SYCAMORE MAPLE



ACERO NATURALE
NATURAL MAPLE

Marmi Marbles



BIANCO CARRARA
CARRARA WHITE



BLACK AND GOLD
BLACK AND GOLD



ONICE MIELE
HONEY ONYX



ONICE ROSA
PINK ONYX

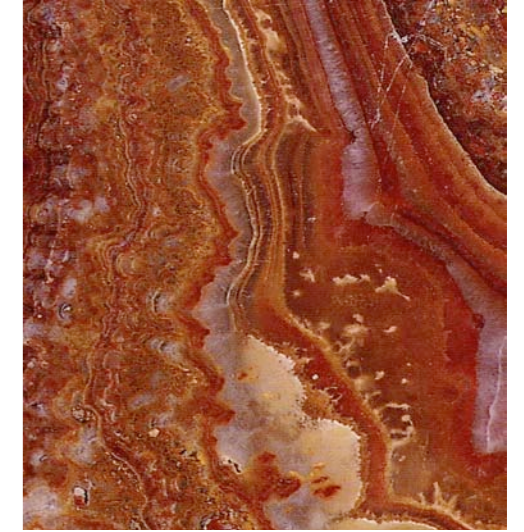

ONICE ROSSO
RED ONYX



BRONZE AMANI
AMANI BRONZE



CREMA DELICATO
DELICATE CREAM

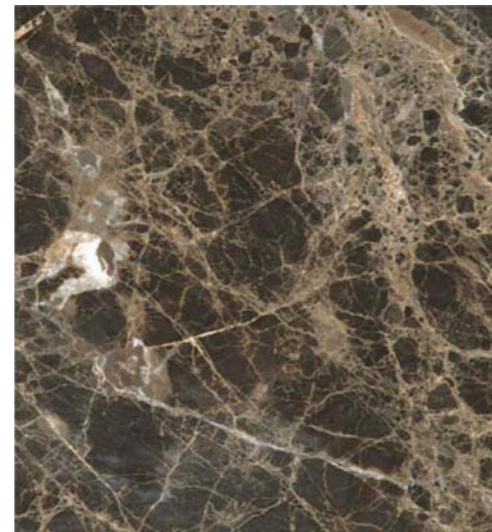

EMPERADOR
EMPERADOR



TRAVERTINO CHIARO
LIGHT TRAVERTINO



CALACATTA ORO
GOLD CALACATTA



ALBA CHIARA
CLEAR ALBA



QUARZITE BRASILIANA
BRAZILIAN QUARTZITE



NERO ASSOLUTO
ABSOLUTE BLACK



NERO PORTORO
BLACK PORTORO



AZUL MACAUBA
AZUL MACAUBA



GIALLO SIENA
YELLOW SIENA



QUARZO ICEBERG
QUARTZ ICEBERG

Metalli

Metals



OTTONE BRONZATO 1
BRONZE-PLATED BRASS 1

OTTONE BRONZATO 2
BRONZE-PLATED BRASS 2

OTTONE BRONZATO 3
BRONZE-PLATED BRASS 3

OTTONE LUCIDO
BRONZE-PLATED BRASS 3

Specchi

Mirrors

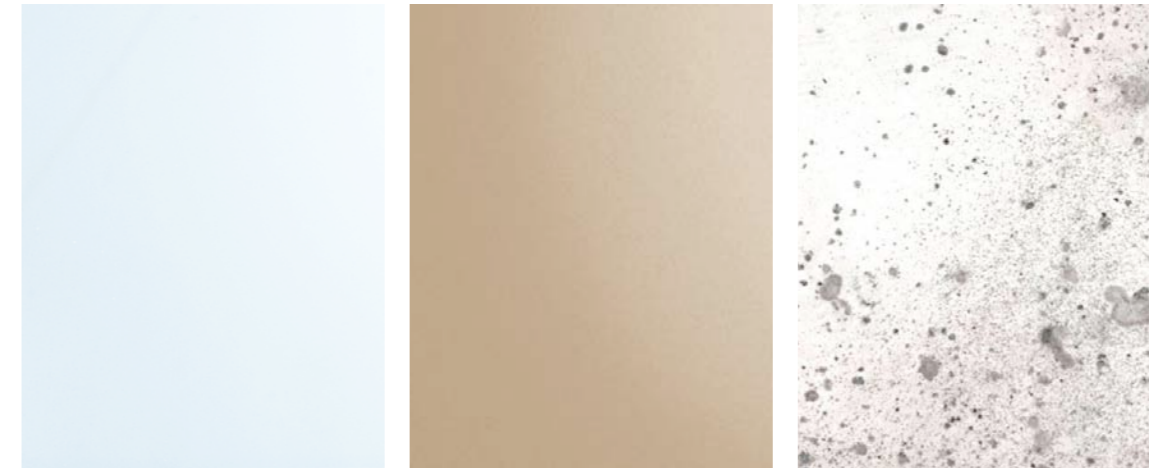

SPECCHIO NATURALE
NATURAL MIRROR

SPECCHIO BRONZATO
BRONZE MIRROR

SPECCHIO ANTICO
ANCIENT MIRROR

Vetri

Glass



SATINATO
SATIN

CROMO
CHROME

ARGENTO
SILVER

NICHEL NERO
NICKEL BLACK



VETRO EXTRACHIARO
EXTRACLEAR GLASS

VETRO ACIDATO
ACID-ETCHED GLASS

VETRO FUMÉ
FUMÉ GLASS

VETRO SATINATO
SATIN GLASS

Indice sinottico

Synoptic Index

Boiserie Collection



Art. 117 - ALFEA

Pag.04

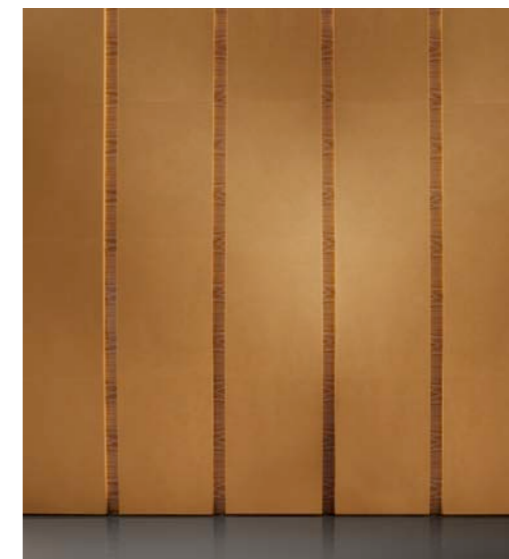

Art. 119 - OLEANDRA

Pag.08

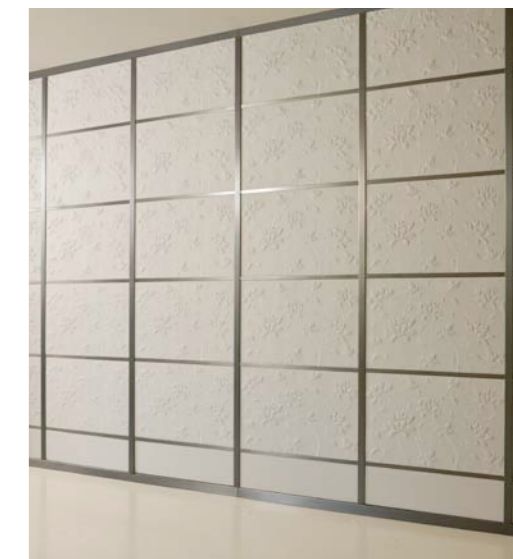

Art. 118 - NINFEA

Pag.06



Art. 110 - ARMONY

Pag.10



Art. 114 - PROMETEO

Pag.12

Refisso Collection



Art. 712 Pag.40



Art. 613 Pag.48

Ossidiana Collection



Art. 809 Pag.56

Hyde Collection



Art. 2501 Pag.94

Prezioso Collection



Art. 1605 Pag.78



Pag.98

Trivio Collection



Art. 214 Pag.14



Art. 214/A Pag.16



Art. 319 Pag.18

Krystal Collection



Art. 1211 Pag.60



Art. 1113/A Pag.62



Art. 1113/B Pag.62



Art. 507 Pag.32



Art. 2113 Pag.82



Art. 2112 Pag.84



Art. 2402 Pag.92



Art. 1312/A Pag.64



Art. 1405 Pag.66

Michelin A Collection



Art. 2601 Pag.38

Oliviero Collection



Art. 713 Pag.54

Alfio Collection



Art. 614 Pag.52

Italo Collection



Art. 215 Pag.20

Altea Collection



Art. 320 Pag.22

Alceo Collection



Art. 508 Pag.35

Balmoral Collection



Art. 612 Pag.50



Art. 711 Pag.46



Art. 808 Pag.58

Eclisse Collection



Art. 410 Pag.36

Oxford Collection



Art. 1210 Pag.68



Art. 1112 Pag.72



Art. 1310/A Pag.74

Titano Collection



Art. 213 Pag.24



Art. 318 Pag.28

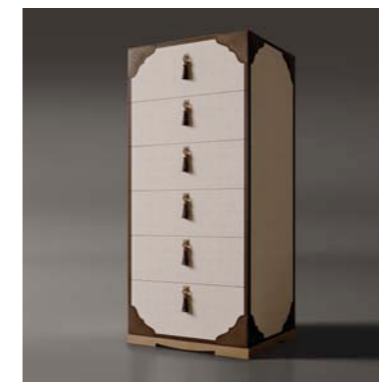

Art. 1404 Pag.76



Art. 1806 Pag.96



Art. 1604 Pag.100



Art. 2106 Pag.90



Art. 2107 Pag.86



Art. 2110 Pag.88



Art. 317 Pag.30

Jackie Collection

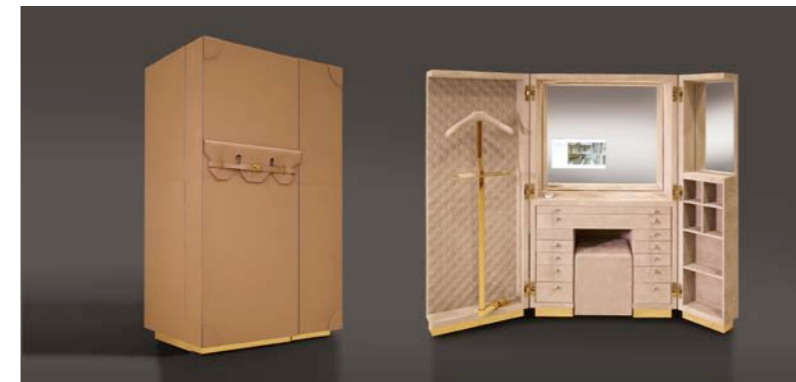

Art. 1005 Pag.80

Il sommier

The bed base



Il sommier è l'ideale per coloro che amano il letto semplice e funzionale e l'arredo libero da schemi; il sommier, non avendo la testata, è posizionabile come si vuole nel locale, sotto un grande arazzo oppure sotto la finestra. È una soluzione molto impiegata negli hotel.

The bed base is ideal for those who love a simple and practical bed, along with furnishings that break the common mould; the bed base, seeing that it doesn't have a headboard, can be positioned anywhere you want in the room, beneath a large tapestry or even below the window. This is a solution that is used a great deal by hotels.

- | | |
|---|--|
| 1_ Fibre di coco <i>Coconut fibers</i> | 6_ Legno di Abete <i>Fir</i> |
| 2_ Fibre vegetali <i>Vegetable fibres</i> | 7_ Feltro <i>Felt</i> |
| 3_ Rivestimento Lino <i>Linen covering</i> | 8_ Molle incordate <i>Strung springs</i> |
| 4_ Resinato <i>Resin</i> | 9_ Molle biconiche <i>Biconical springs</i> |
| 5_ Ovatta di cotone <i>Cotton wadding</i> | |



I materassi

The mattresses



Materasso modello ortopedico con molleggio tradizionale 2.2 h cm 22/25.

Materasso con rivestimento esterno in tessuto Cashmere personalizzato; imbottitura lato estivo in cotone bianco, lato invernale in lana bianca; poliuretano espanso indeformabile e feltro agugliato termo fissato ad alta densità; molleggio a molle tradizionali ortopedico in acciaio temperato armonico diametro 2.20; sistema box, tamponi perimetrali in poliuretano espanso indeformabile D.30 kg/mq, ad alta resistenza.

Orthopaedic mattress with traditional suspension system: 2.2 h cm 22/25.

Mattress with outer covering in personalized Cashmere; summer side padding in white cotton, winter side in white wool; expanded non-deformable polyurethane and needled felt with thermal-set high density; traditional orthopaedic suspension on springs in hardened spring steel with a diameter of 2.20; box System, perimeter pads in expanded non-deformable polyurethane with density of 30 kg/sqm – high strength.



Materasso modello ortopedico con molleggio tradizionale 2.2 h cm 22/25 con Memory.

Lastra in materiali modellanti Memory Foam; materasso con rivestimento esterno in tessuto Cashmere personalizzato; imbottitura lato estivo in cotone bianco, lato invernale in lana bianca; poliuretano espanso indeformabile e feltro agugliato termo fissato ad alta densità; molleggio a molle tradizionali ortopedico in acciaio temperato armonico diametro 2.20; sistema box, tamponi perimetrali in poliuretano espanso indeformabile D.30 kg/mq, ad alta resistenza.

Orthopaedic mattress with traditional suspension system: 2.2 h cm 22/25 with Memory Foam.

Memory Foam sheet mattress; mattress with outer covering in personalized Cashmere; summer side padding in white cotton, winter side in white wool; expanded non-deformable polyurethane and needled felt with thermal-set high density; traditional orthopaedic suspension on springs in hardened spring steel with a diameter of 2.20; box System, perimeter pads in expanded non-deformable polyurethane with density of 30 kg/sqm – high strength.

Materasso con molle indipendenti h cm 22/25.

Materasso con rivestimenti interni ed esterni in tessuto Cashmere personalizzato; imbottitura lato estivo in cotone bianco, lato invernale in lana; poliuretano espanso indeformabile e feltro agugliato termo fissato ad alta densità; molleggio a molle insacchettate indipendenti a 7 zone di portata differenziata in acciaio temperato armonico diametro 2.0 - 2.20; sistema box, tamponi perimetrali in poliuretano espanso indeformabile D.30 kg/mq, ad alta resistenza.

Mattress with independent springs: h 22/25 cm.

Mattress with outer and inner covering in personalized Cashmere; summer side padding in white cotton, winter side in white wool; expanded non-deformable polyurethane and needled felt with thermal-set high density; suspension with independent pocket springs in 7 different support areas in hardened spring steel with a diameter of 2.20; box System, perimeter pads in expanded non-deformable polyurethane with density of 30 kg/sqm – high strength.



Materasso modello ortopedico con molleggio tradizionale 3.0 h più Topper in Memory/Water air/Water gel.

Materasso con rivestimento esterno in tessuto Cashmere personalizzato rimovibile e lavabile; imbottitura lato in Memory/Water air/Water gel; rivestimento interno in tessuto Cashmere personalizzato; poliuretano espanso indeformabile e feltro agugliato termo fissato ad alta densità; molleggio a molle tradizionali ortopedico in acciaio temperato armonico diametro 2.20; sistema box, tamponi perimetrali in poliuretano espanso indeformabile D.30 kg/mq, ad alta resistenza.

Orthopaedic mattress with traditional suspension system: 3.0 h plus Topper in Memory-Water air-Water gel combination.

Mattress with outer covering in personalized Cashmere that is removable and washable; padding in Memory-Water air-Water gel combination; inner covering in personalized Cashmere; expanded non-deformable polyurethane and needled felt with thermal-set high density; traditional orthopaedic suspension on springs in hardened spring steel with a diameter of 2.20; box System, perimeter pads in expanded non-deformable polyurethane with density of 30 kg/sqm – high strength.



Design: CRS LUDOVICA MASCHERONI
in collaborazione con: SARAH DE ANGELIS

AD: Emanuele Missaglia
Progetto grafico: galvanietremolada.it
Ph: masterfotografie
galvanietremolada.it
Print: Grafiche Boffi

LUDOVICA MASCHERONI

HOME ATELIER

LUDOVICA MASCHERONI

Via Don Luigi Fumagalli, 97/99
22066 MARIANO C.SE (CO) ITALY
tel. +39 031 764203
www.ludovicamascheroni.eu
info@ludovicamascheroni.eu

LUDOVICA MASCHERONI

Via Luigi Cadorna 21
20821 MEDA (MB) ITALY
Tel. +39 0362 342885

Nessuna parte di questo catalogo, testo o fotografia può essere riprodotta o trasmessa in qualsiasi forma o tramite mezzo elettronico o meccanico, comprese le fotocopie, senza previo permesso scritto da parte della società LUDOVICA MASCHERONI.

No part of this catalogue, text or photograph may be reproduced or transmitted in any shape or form, through electronic or paper-based communication, including photocopies, without the prior express written consent of LUDOVICA MASCHERONI.

I colori dei legni, delle laccature, dei tessuti e delle pelli presenti in questo catalogo sono suscettibili dei procedimenti di stampa. Fa fede il campionario dell'azienda. LUDOVICA MASCHERONI si riserva la facoltà di modificare in qualunque momento e senza preavviso le caratteristiche tecniche (misure, finiture, tessuti e pelli) dei suoi prodotti.

Wood, lacquer, fabric and leather colours are not binding and may vary due to printing. Please refer to the company sets of samples. LUDOVICA MASCHERONI reserves the right to modify the technical specifications of the products (sizes, finishes, leather and fabrics) featured in this catalogue at any time and without prior notice.

